

# PIPE INSTALLATION

OPTIONS FOR THE INSTALLATION OF Groundbreaker®

OPTION 2

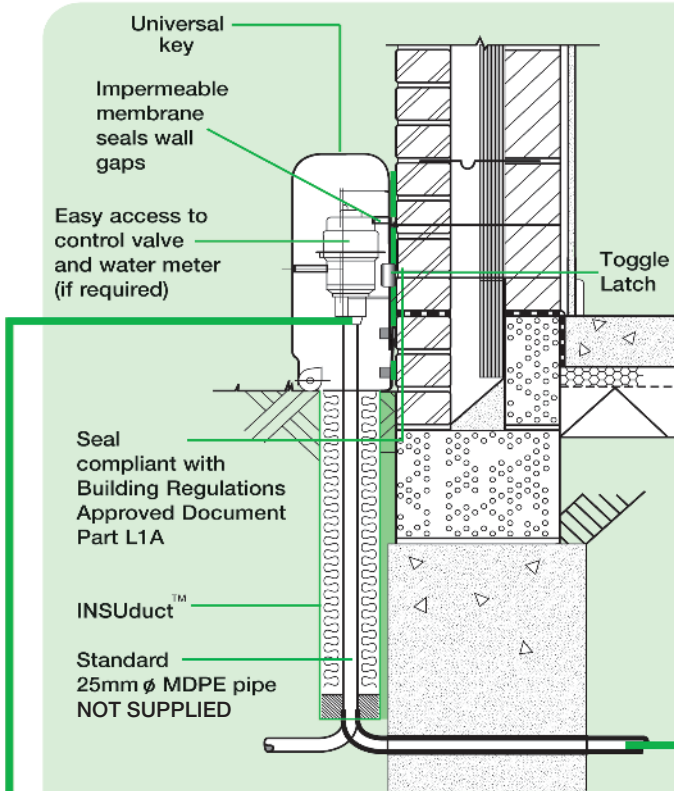

## OPTION 2

### UNDER FOOTINGS

Remove 90° pre-formed bend from Groundbreaker® and pipe through under the floor as traditional installations.

## CONNECTION DETAIL

### Universal Pipe Connection



**Failure to install Groundbreaker to this specification will eliminate the manufacturers guarantee and may result in a water company refusing to connect the water service**

To view installation video - visit [www.groundbreaker.co.uk](http://www.groundbreaker.co.uk)